

£410,000

Harrowby Street, Marylebone, W1H



1 Bedroom



1 Bathroom



1 Reception

Bright one double bedroom apartment situated in a 24 hour portered block, located in Harrowby Street W1H

This apartment is situated in Marble Arch Apartments, a twenty four hour portered block. In fair condition throughout with separate fitted kitchen, reception room, double bedroom and full bathroom. Offered for sale with vacant possession and a 977 year lease.

This well looked after block is located a ten minute walk to Baker Street, with all the excellent cafes, restaurants and shops. Marylebone main line station is close by as is Hyde Park, Paddington and Oxford Street. An ideal location!

- ✓ Entrance Hall
- ✓ Reception
- ✓ Fitted Kitchen
- ✓ Double Bedroom
- ✓ Bathroom with 3 piece suite
- ✓ Large Fitted Wardrobes
- ✓ 24 Hour Portered Block
- ✓ Entry Phone System
- ✓ 977 year lease approximately
- ✓ Communal Central Heating & Hot Water

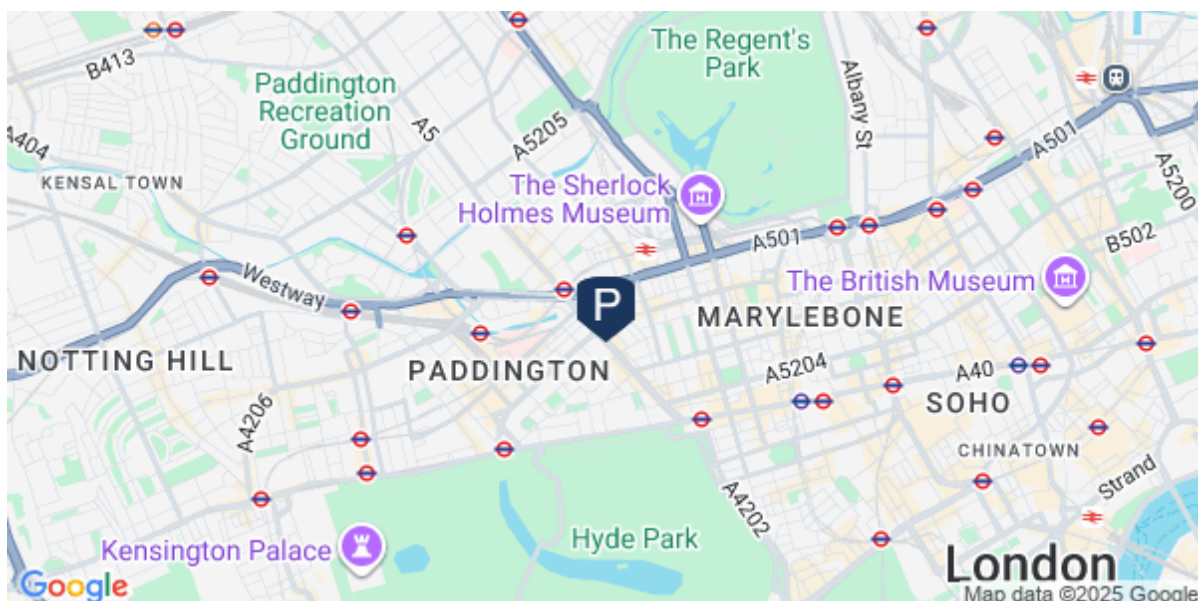
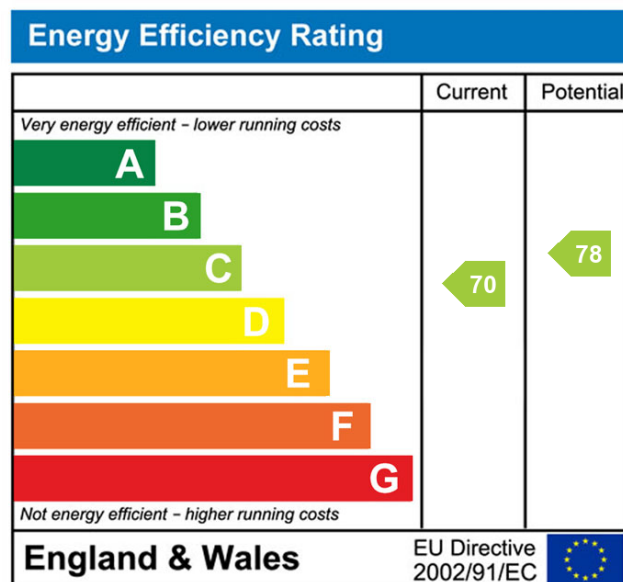

MARBLE ARCH APARTMENTS W1H

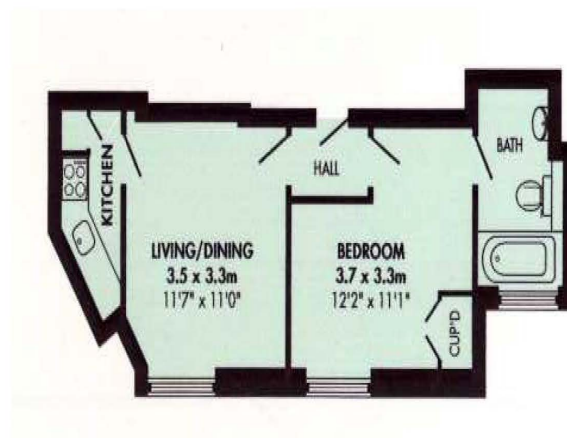

325 Square footage

30.1 Square Meters