

£410,000

Marble Arch Apartments, Marylebone, W1H



Studio



1 Bathroom



No

Charming and bright double Studio Apartment offered for sale in good condition in popular 24 hour portered block.

This apartment has a partially separated bedroom area to the reception area. A fitted kitchen and fully tiled shower room.

Situated in Marble Arch Apartments, a well known block in Marylebone. A ten minute walk to Baker Street, Marble Arch and Paddington. Boutique shopping and coffee shops at Connaught Village and nearest Underground Station is Edgware Road.

- ✓ Entrance Hall
- ✓ Double Studio Room
- ✓ Fitted Kitchen
- ✓ Fully Tiled Shower Room/wc
- ✓ Independent Central Heating
- ✓ Entry Phone System
- ✓ 24 Hour Portered Block
- ✓ Approx 977 years lease
- ✓ Good Condition Throughout
- ✓ 10 Minutes Walk to Marble Arch & Oxford Street

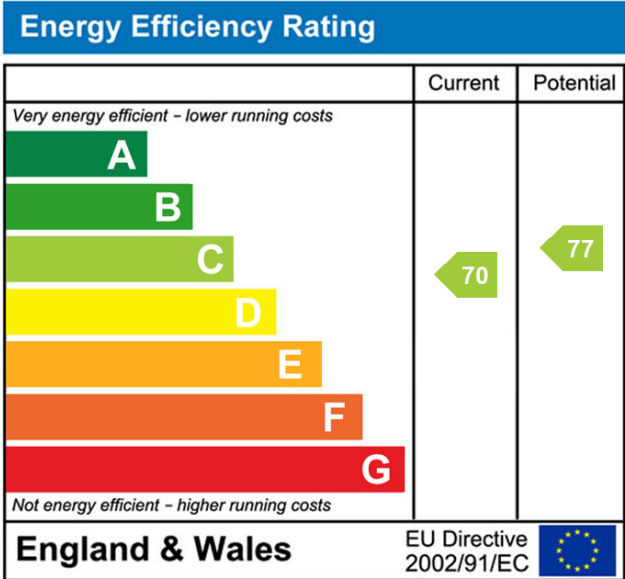

***FLAT MARBLE ARCH
APARTMENTS***

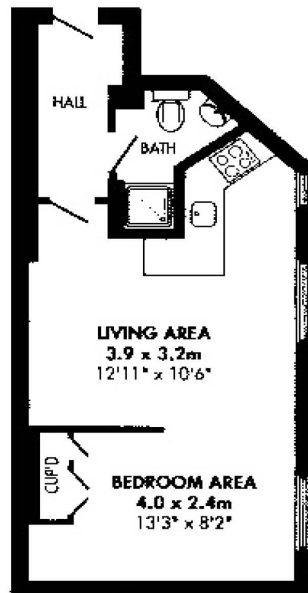

332 Square Footage

30.8 Square Meters